

BO2826N2B $\varnothing 27.6\text{mm} \times 25.8\text{mm}$, 外转子无传感器 Outer Rotor, Sensorless

应用领域: 无人机、电动工具、自动化设备、智能家居等驱动领域。

Applications: UAV, electrical tools, automation equipment, smart home, etc.

				01-104-12.0	02-104-24.0	03-104-36.0
电机参数 / Motor Data						
1	电压	Voltage	V	12.0	24.0	36.0
2	端电阻	Terminal resistance	Ω	0.14	0.58	1.26
3	空载转速	No-load speed	rpm	10400	10400	10400
4	空载电流	No-load current	A	0.44	0.23	0.15
5	堵转转矩	Stall torque	mNm	930	912	931
6	堵转电流	Stall current	A	83.3	41.7	28.6
7	额定转矩	Nominal torque	mNm	86.7	89.5	89.6
8	额定转速	Nominal speed	rpm	7820	8040	8500
9	额定电流	Nominal current	A	8.1	4.1	2.7
10	最大输出功率	Max. output power	W	247	248	254
11	最大效率	Max. efficiency	%	86	85.7	86.2
12	反电势常数	Back-EMF constant	mV/rpm	1.1	2.3	3.4
13	转矩常数	Torque constant	mNm/A	10.9	22	32.8
14	电感	Terminal inductance	mH	871	433	290
15	转速 / 转矩斜率	Speed/torque gradient	rpm/mNm	11.6	11.4	11.2
16	转子惯量	Rotor inertia	gcm^2	31	31	31
17	重量	Weight	g	53	53	53

热参数 / Thermal Data			
18	热阻 (机壳 - 环境)	Thermal resistance housing-ambient	K/W 1.7
19	热阻 (线圈 - 机壳)	Thermal resistance winding-housing	K/W 1.8
20	热时常数 (电机)	Thermal time constant motor	s 300
21	热时常数 (线圈)	Thermal time constant winding	s 43
22	工作温度范围	Operating temperature range	$^{\circ}\text{C}$ -40~+120
23	绕组耐温等级	Thermal class of winding	$^{\circ}\text{C}$ 180

特性曲线 / Characteristics Curve

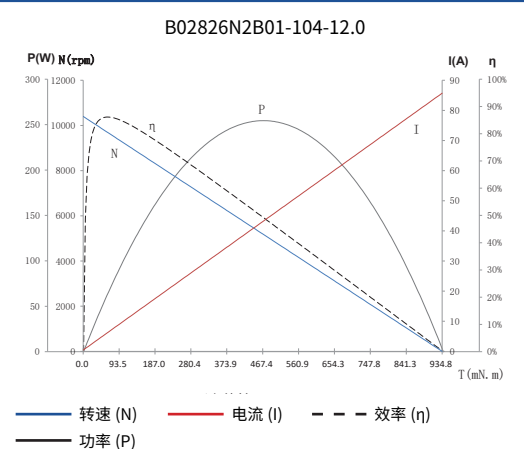

机械参数 / Mechanical Data			
24	轴向间隙	Axial play	mm 0.014
25	径向间隙	Radial play	mm 0.008
26	动态轴向载荷	Axial load dynamic	N 5
27	静态轴向载荷	Axial load static	N 80
28	径向载荷 (距安装面 3mm)	Radial load at 3 mm from mounting face	N 29

其它参数 / Other Specifications			
29	极对数	No. of pole pairs	7
30	滚珠轴承	Ball bearings	2
31	换向结构	Commutation structure	sensorless
32	防护等级	Protection class	IP20

端子定义 / Connection

可选配置 / Options		端子定义 / Connection	
齿轮箱: 行星齿轮 Gearbox: planetary gearbox	齿轮组主要技术指标详见第 157 页 the main technical parameters are detailed on page 157	A 霍尔传感器 / hall sensor AWG 26	B 无传感器 / sensorless AWG 22
性能 Special coils: 连续运行范围内可定制 customizable in continuous operation range		Pin1 Hw green	Pin1 U red
编码器 Encoder/ 驱动器 Driver: 可定制 customizable upon request		Pin2 Hv grey	Pin2 V white
法兰 Flange: 标准前后法兰 standard front and rear flanges / 定制法兰 custom flanges		Pin3 Hu brown	Pin3 W black
轴 Shaft: 长度 length / 异形 shape		Pin4 + red	
轴承类型 Bearing type: 含油轴承 sleeve bearings / 滚珠轴承 ball bearings		Pin5 - black	
电气连接 Electrical connection: 端子或导线 connector or wire / 导线长度 lead wires length		Pin6 U white	
		Pin7 W white	
		Pin8 V yellow	

外观图 / Outline Drawing

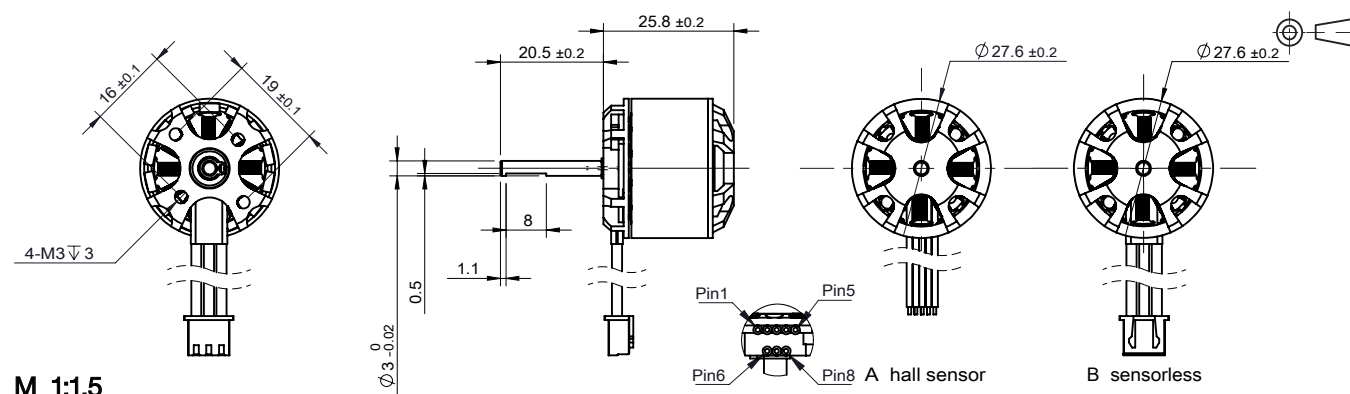

规格如有变更, 恕不另行通知。Specification subject to change without notice.