

# BO1709NB2B $\varnothing 17\text{mm} \times 9.5\text{mm}$ , 外转子无传感器 Outer Rotor, Sensorless

应用领域: 无人机云台、激光雷达、激光扫描、手持云台。

Applications: UAV gimbals, LiDAR, laser scanner, handheld gimbals.

	02-260-5.0	01-260-10.0	03-260-15.0
--	------------	-------------	-------------

电机参数 / Motor Data			
1 电压	Voltage	V	5.0
2 端电阻	Terminal resistance	$\Omega$	1.1
3 空载转速	No-load speed	rpm	26000
4 空载电流	No-load current	mA	240
5 堵转转矩	Stall torque	mNm	7.5
6 堵转电流	Stall current	mA	4550
7 额定转矩	Nominal torque	mNm	1.9
8 额定转速	Nominal speed	rpm	16250
9 额定电流	Nominal current	mA	1370
10 最大输出功率	Max. output power	W	5.1
11 最大效率	Max. efficiency	%	59
12 反电势常数	Back-EMF constant	mV/rpm	0.182
13 转矩常数	Torque constant	mNm/A	1.7
14 KV 值	KV Value	rpm/V	5200
15 转速 / 转矩斜率	Speed/torque gradient	rpm/mNm	3460
16 转子惯量	Rotor inertia	$\text{gcm}^2$	1.2
17 重量	Weight	g	8.8

热参数 / Thermal Data			
18 热阻 (机壳 - 环境)	Thermal resistance housing-ambient	K/W	15.4
19 热阻 (线圈 - 机壳)	Thermal resistance winding-housing	K/W	13.6
20 热时常数 (电机)	Thermal time constant motor	s	128
21 热时常数 (线圈)	Thermal time constant winding	s	43
22 工作温度范围	Operating temperature range	$^{\circ}\text{C}$	-40~+120
23 绕组耐温等级	Thermal class of winding	$^{\circ}\text{C}$	155

机械参数 / Mechanical Data			
24 轴向间隙	Axial play	mm	0.012
25 径向间隙	Radial play	mm	0.008
26 动态轴向载荷	Axial load dynamic	N	1.5
27 静态轴向载荷	Axial load static	N	37
28 径向载荷 (距安装面 3mm)	Radial load at 3 mm from mounting face	N	12

其它参数 / Other Specifications			
29 极对数	No. of pole pairs		4
30 滚珠轴承	Ball bearings		2
31 换向结构	Commutation structure	sensorless	
32 防护等级	Protection class	IP20	

### 特性曲线 / Characteristics Curve

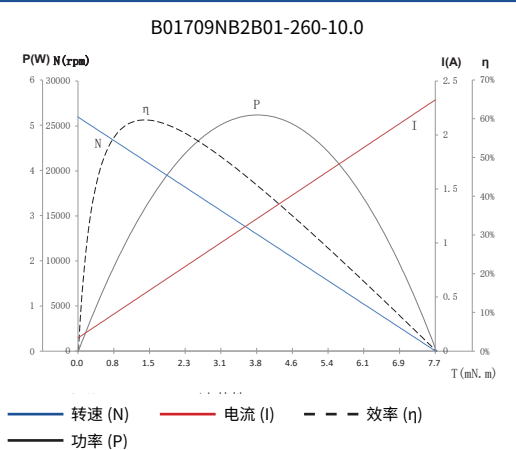

仅供参考, 详细了解请以产品规格书为准。  
For reference only, please refer to the product specification.

### 可选配置 / Options 端子定义 / Connection

齿轮箱: 行星齿轮  
Gearbox: planetary gearbox

性能 Special coils: 连续运行范围内可定制 customizable in continuous operation range

编码器 Encoder/ 驱动器 Driver: 可定制 customizable upon request

法兰 Flange: 标准前后法兰 standard front and rear flanges / 定制法兰 custom flanges

轴 Shaft: 长度 length / 异形 shape

轴承类型 Bearing type: 含油轴承 sleeve bearings / 滚珠轴承 ball bearings

电气连接 Electrical connection: 端子或导线 connector or wire / 导线长度 lead wires length

无传感器 / sensorless  
AWG 30

Pin1	U	white
Pin2	V	red
Pin3	W	black

### 外观图 / Outline Drawing

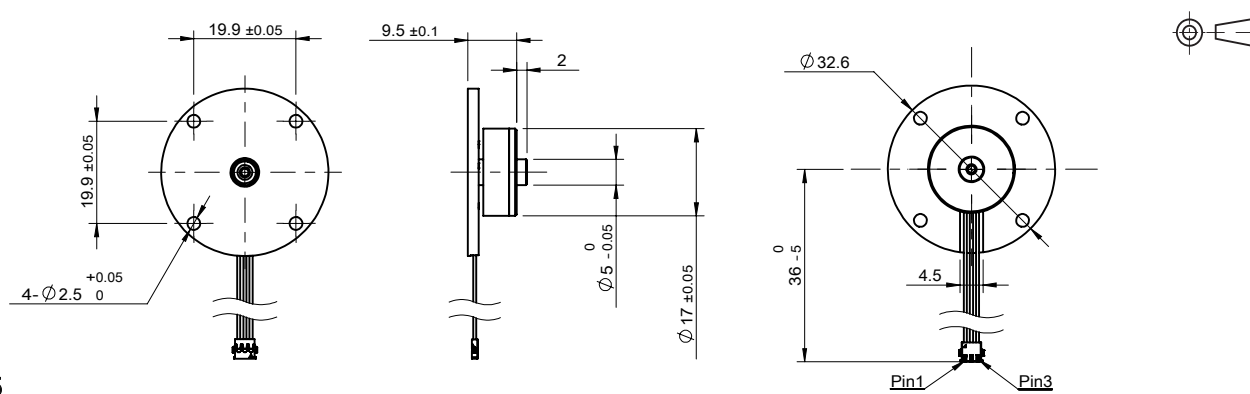

M 1:1.5

规格如有变更, 恕不另行通知。Specification subject to change without notice.

www.constarmotor.com

精密直流空心杯电机  
PRECISION DC CORELESS MOTOR

无刷电机  
BRUSHLESS DC MOTOR

驱动器  
CONTROLLER

精密齿轮减速电机  
PRECISION GEAR MOTOR

精密伺服电机  
PRECISION SERVO MOTOR

直流空心杯电机  
DC CORELESS MOTOR

直流铁芯电机  
DC CORE MOTOR

声波振动电机  
SONIC MOTOR

全球营销网络  
GLOBAL MARKETING NETWORK